



**T&S BRASS AND BRONZE WORKS, INC.**

2 Saddleback Cove / P.O. Box 1088  
Travelers Rest, SC 29690

Model No.

**B-0193**

Item No.

Travelers Rest, SC: 800-476-4103 • Simi Valley, CA: 800-423-0150 • Fax: 864-834-3518 • www.tsbrass.com

This Space for Architect/Engineer Approval

Job Name \_\_\_\_\_ Date \_\_\_\_\_

Model Specified \_\_\_\_\_ Quantity \_\_\_\_\_

Customer/Wholesaler \_\_\_\_\_

Contractor \_\_\_\_\_

Architect/Engineer \_\_\_\_\_

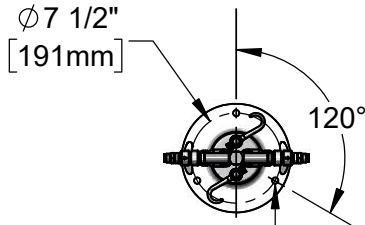

(3) Bolt Holes  
for  $\phi 1/2"$  x 3"  
Hex Head Bolts &  
Expansion Shields  
(Included)

EB-0107-035  
High Flow Angled  
Spray Valve  
(Blue)

(2) B-0970-FE  
3/8" NPT Vacuum  
Breakers

Pot Filling  
Hook Nozzle

Items Not Shown  
For Clarity

Swivel Joint

(2) 002852-40  
Hook & Bolt

EB-0068-H  
Flexible Stainless  
Steel Hose w/ Blue  
Grip Handle

47 13/16"  
[1215mm]

EB-0104-H  
Flexible Stainless  
Steel Hose w/  
Blue Grip  
Handle

Hot Cold

1/2" Check Valves

6"  
[152mm]

Mounting  
Surface

12"  
[305mm]  
Appx. When  
Hose is Hanging

12"  
[305mm]  
Appx. When  
Hose is Hanging

$\phi 9 1/16"$   
[230mm]

**Rough-In Requirement:**  
Assembly Connects to a 1/2" Pipe Nipples Roughed in  
From Floor on 2" Centers to a Height of 6"

**Product Specifications:**  
Kettle Kaddy Combination Kettle Filler Spray Stanchion, Control Valves,  
(2) 3/8" NPT Vacuum Breakers, 104" and 68" Flexible Stainless Steel Hoses,  
Hook Nozzle, High Flow Spray Valve & (2) 1/2" Check Valves

**Product Compliance:**  
ASME A112.18.1 / CSA B125.1  
NSF 61 - Section 9  
NSF 372 (Low Lead Content)  
EPA Act 2005 Non-Compliant (PRSV)  
CSA B64.8 (VB)



# T&S BRASS AND BRONZE WORKS, INC.

2 Saddleback Cove / P.O. Box 1088  
Travelers Rest, SC 29690

Model No.

**B-0193**

Item No.

Travelers Rest, SC: 800-476-4103 • Simi Valley, CA: 800-423-0150 • Fax: 864-834-3518 • www.tsbrass.com

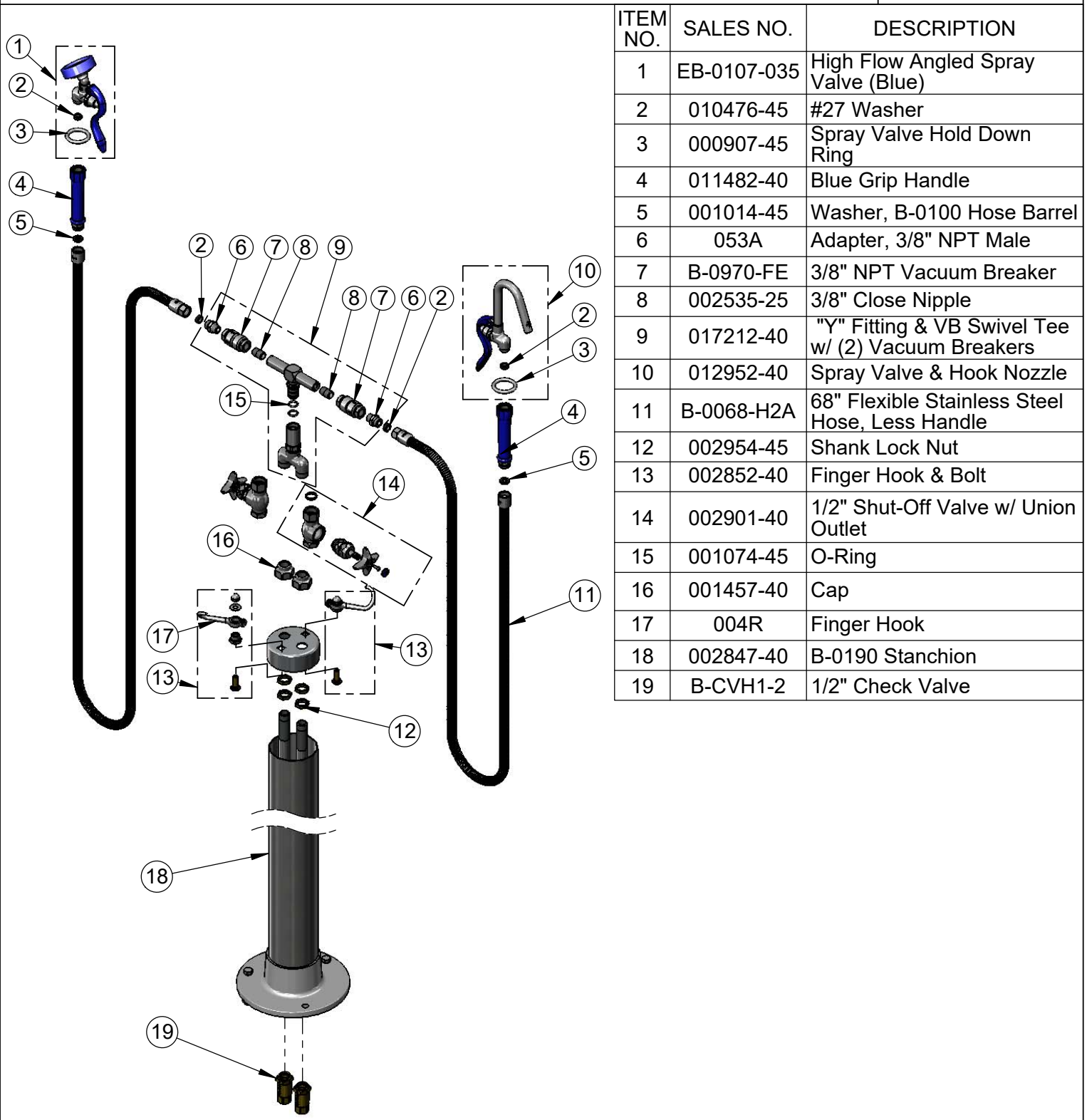

ITEM NO.	SALES NO.	DESCRIPTION
1	EB-0107-035	High Flow Angled Spray Valve (Blue)
2	010476-45	#27 Washer
3	000907-45	Spray Valve Hold Down Ring
4	011482-40	Blue Grip Handle
5	001014-45	Washer, B-0100 Hose Barrel
6	053A	Adapter, 3/8" NPT Male
7	B-0970-FE	3/8" NPT Vacuum Breaker
8	002535-25	3/8" Close Nipple
9	017212-40	"Y" Fitting & VB Swivel Tee w/ (2) Vacuum Breakers
10	012952-40	Spray Valve & Hook Nozzle
11	B-0068-H2A	68" Flexible Stainless Steel Hose, Less Handle
12	002954-45	Shank Lock Nut
13	002852-40	Finger Hook & Bolt
14	002901-40	1/2" Shut-Off Valve w/ Union Outlet
15	001074-45	O-Ring
16	001457-40	Cap
17	004R	Finger Hook
18	002847-40	B-0190 Stanchion
19	B-CVH1-2	1/2" Check Valve

**Product Specifications:**  
Kettle Kaddy Combination Kettle Filler Spray Stanchion, Control Valves, (2) 3/8" NPT Vacuum Breakers, 104" and 68" Flexible Stainless Steel Hoses, Hook Nozzle, High Flow Spray Valve & (2) 1/2" Check Valves

**Product Compliance:**  
ASME A112.18.1 / CSA B125.1  
NSF 61 - Section 9  
NSF 372 (Low Lead Content)  
EPA Act 2005 Non-Compliant (PRSV)  
CSA B64.8 (VB)